



Codice - Code:

E89611

Rectangular waterfall spout

Descrizione - Description:

Cascata a parete filo muro rettangolare 200x120mm con attacco 1/2" M

Rectangular cascade showerhead 200x120 mm with 1/2" M connection

Rechteckig Wand-Einbau Schwallbrause 200x120mm mit 1/2" aG Verbindung

Cascade murale rectangulaire 200x120 mm avec connexion 1/2" M

Boca cascada rectangular ras de pared 200x120 mm. Conexión 1/2" M.

Каскад скрытого монтажа прямоугольной формы 200x120 мм, соединение 1/2" M

Tecnologia - Technology:



Immagine Prodotto - Product Image



Disegni - Drawings



Grafico di portata - Flow rate diagram

	rain
0	0,0
0,5	5,1
1	7,3
1,5	8,8
2	10,2
2,5	11,1
3	12,2
3,5	13,2
4	13,9
4,5	14,6
5	14,9
pressure bar	flow rate L/min

WITH FLOW REGULATOR
15 L/min

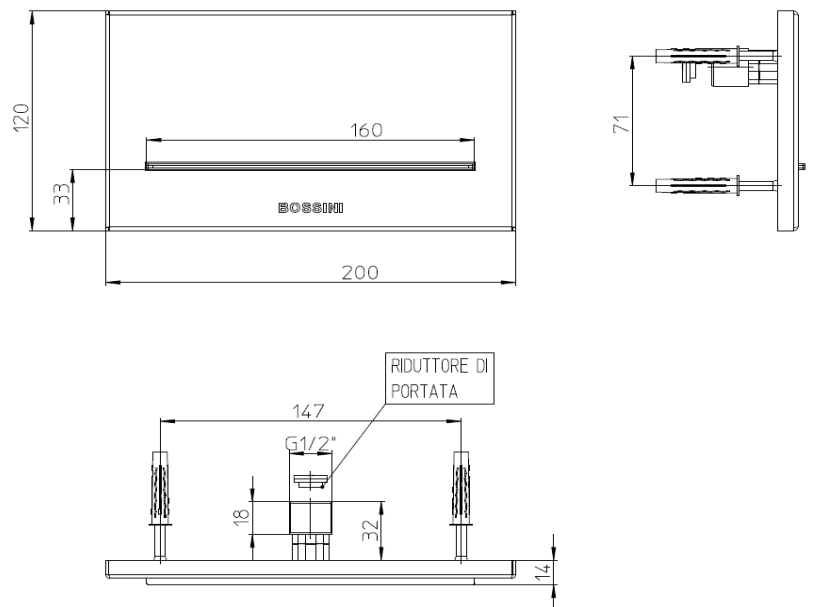
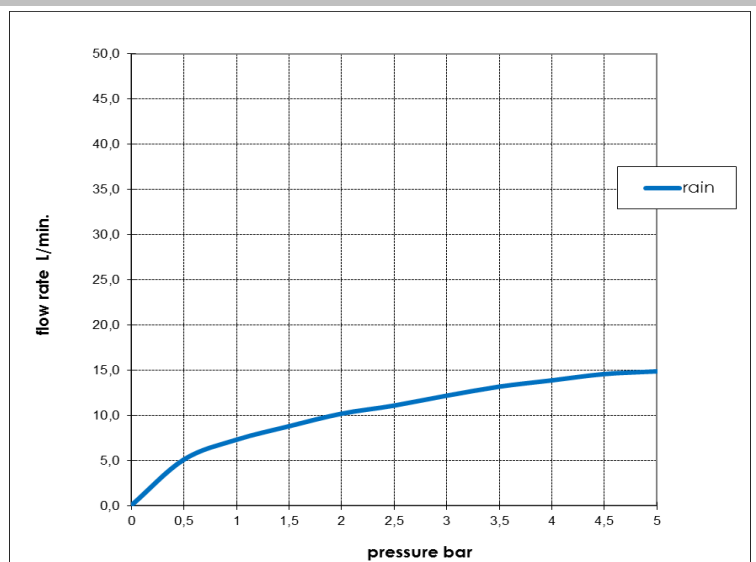

Caratteristiche idrauliche - Hydraulic features

	Pressione Pressure	Portata Flow rate	Solo per miscelatori termostatici Only for thermostatic mixers	
min	1 bar	7,3 L/min	Blocco di sicurezza Safety lock	--
max	5 bar	14,9 L/min	Temperatura acqua fredda Cold water temperature	--
Portata minima consigliata per buon funzionamento Recommended minimum flow-rate for optimal performance		12 L/min	Temperatura acqua calda Hot water temperature	--

Materiali - Materials

Corpo bocca: Acciaio inox AISI304

Rosone: Acciaio inox AISI304

Raccordo di connessione: Ottone

Waterfall spout: Stainless steel AISI304

Flange: Stainless steel AISI304

Inlet fitting: Brass

Certificazioni - Certifications

Conformità - Conformity